

## InSight AI-Cytology – Canine/Feline Pleural and Abdominal Effusion

### Step 1

#### Pleural/Abdominal Effusion Turbidity Card

Please place the tube here



Check the clarity of  
the text on the  
back of the sample  
tube to confirm  
the sample  
turbidity.



#### **Turbid Sample Detected**

Follow the operating  
procedure guidelines  
and select a different  
sample volume.

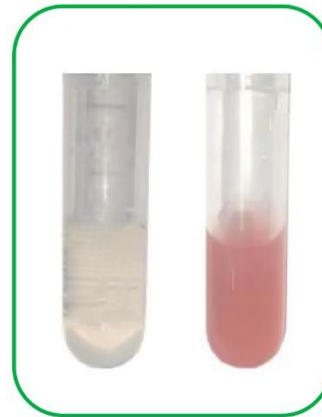

#### **Slightly Turbid Sample**

Mix thoroughly then add  
150µl.

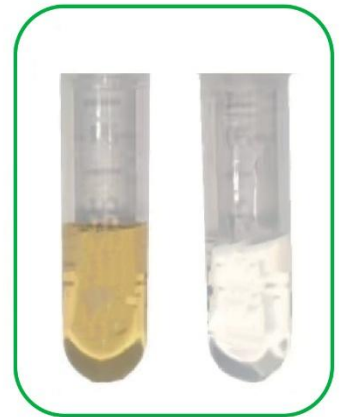

#### **Clear and Transparent Sample Detected**

Follow the operating  
procedure guidelines to  
proceed.

### **NOTE:**

**When the sample turbidity is between two limits, select the sample volume of the clearer turbidity for testing.**

**Use the button on the right to select sample  
transparency and colour**



## Step 2

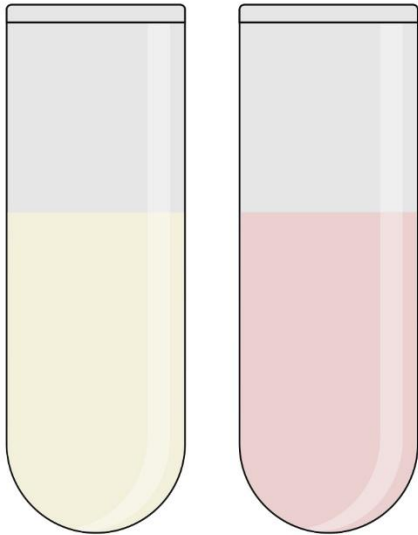

**Clear and Transparent Sample**

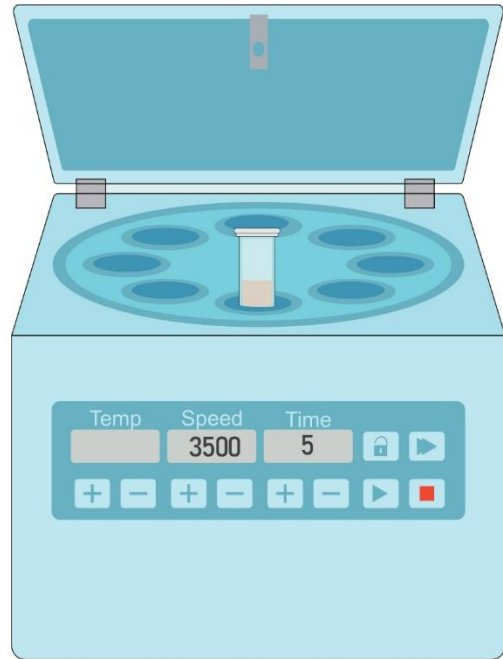

**Centrifuge 2ml – 5ml at  
3500 RPM for 5 minutes.**

### Step 3

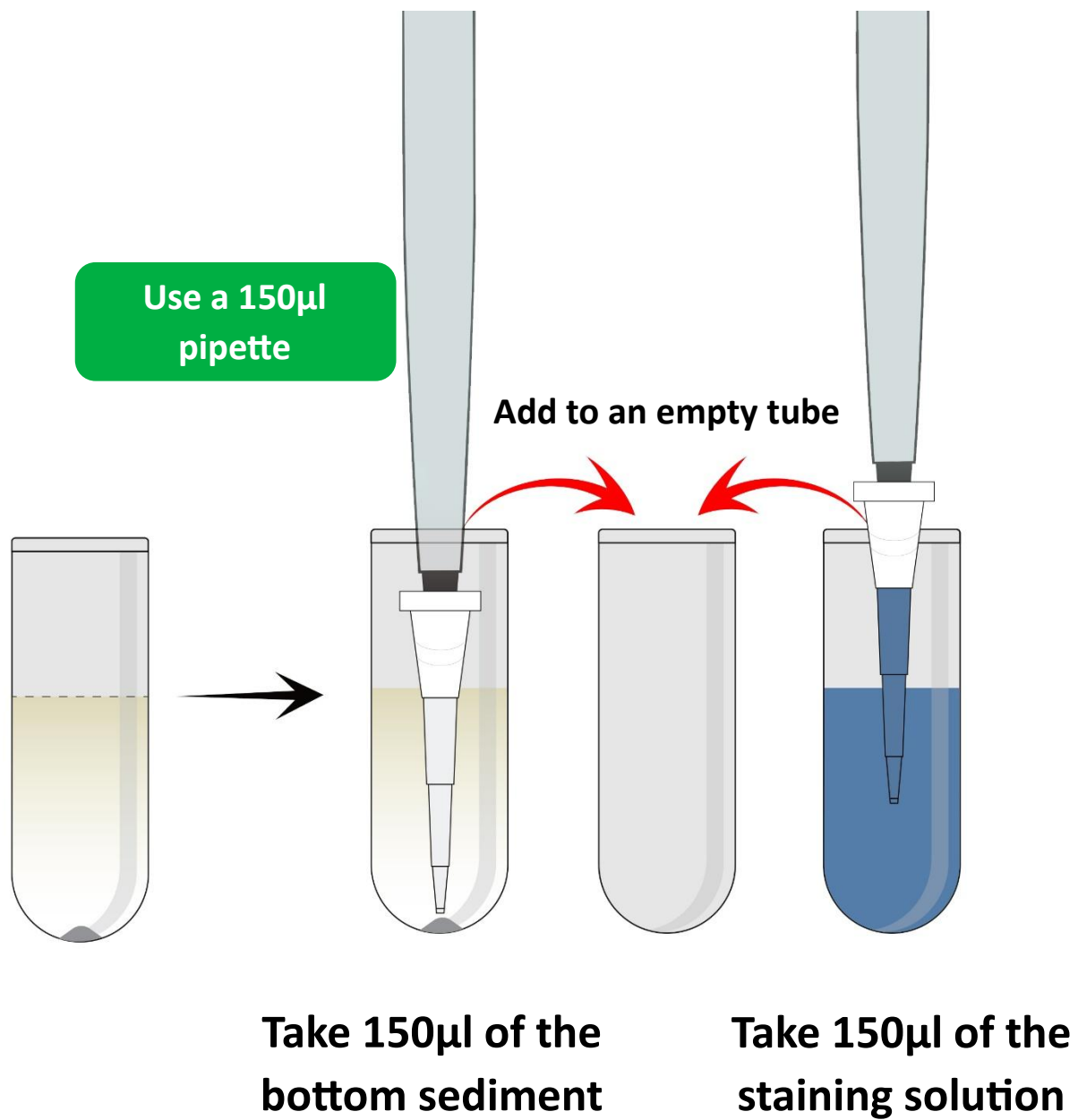

**Step 4**

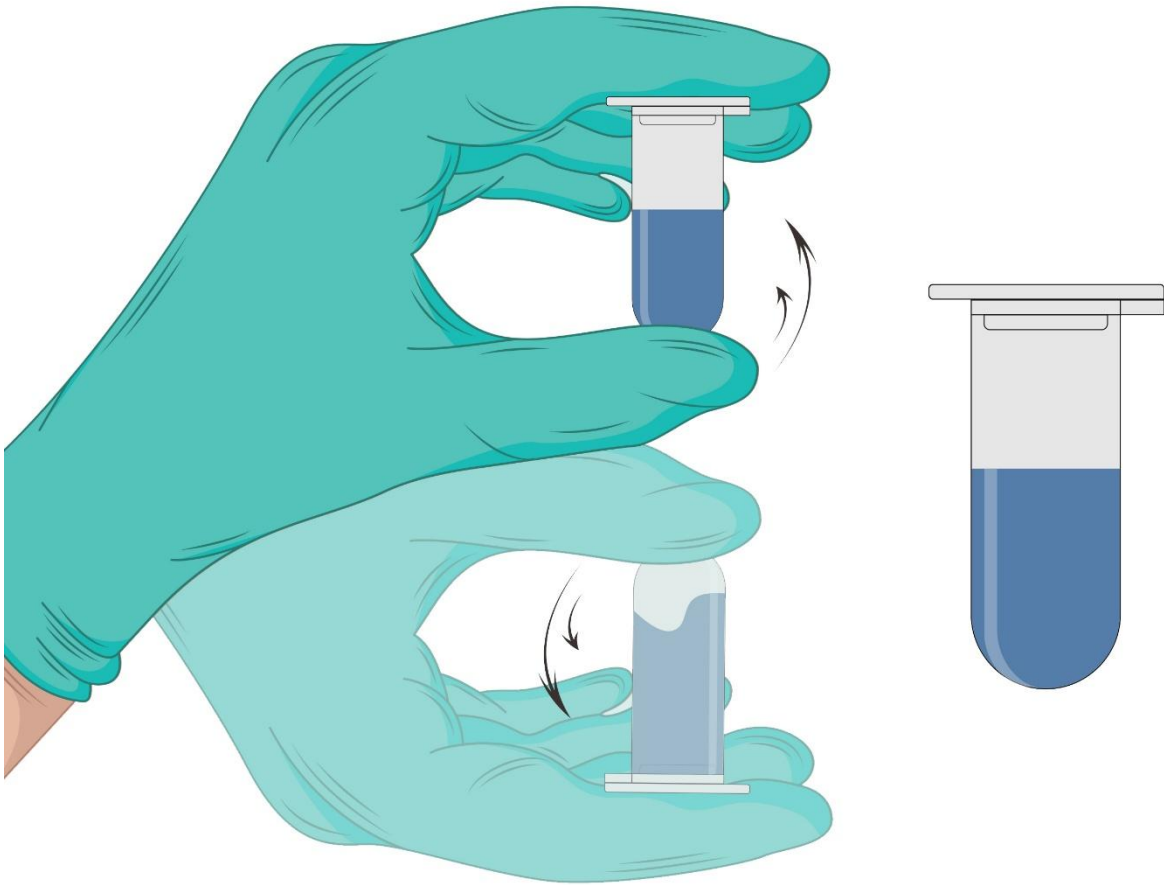

**Invert and mix thoroughly**

## Step 5

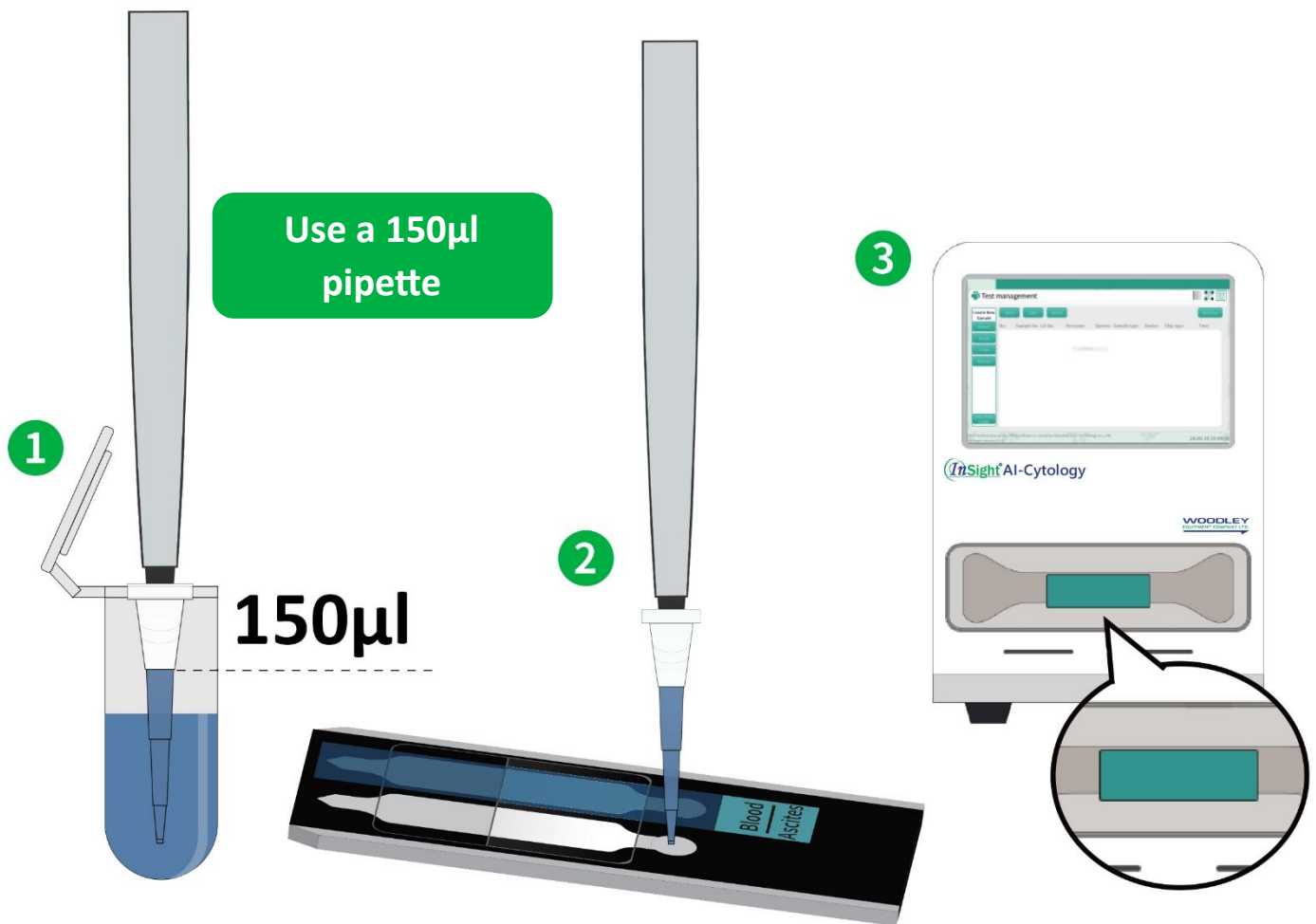

**Mix thoroughly then add 150µl into the slide for testing.**

**Discard the opened, used staining solution.**